







## Bianca Shower Mixer 80mm Plate

### Finish & SKU

 <b>Chrome</b> NR321511dCH	 <b>Brushed Nickel</b> NR321511dBN
 <b>Matte Black</b> NR321511dMB	 <b>Brushed Gold</b> NR321511dBG
 <b>Brushed Bronze</b> NR321511dBZ	 <b>Gun Metal</b> NR321511dGM



### Specifications

#### Watermark License

WM-060073

#### Temperature Rating

Min 1°C-Max 75°C

#### Pressure Rating

Min 150kpa-Max 500kpa

### Warranty



Lead Free

### Features

- 35mm ceramic cartridge can be adjusted to control water temperature and flow control setting, saving energy
- Metal wall plate construction for longevity
- Body inlets – ½ BSP female
- Suitable for mains pressure installation
- Wels rating not required
- Replaceable trim kits
- Packed Separately (Body and Trim Kits)

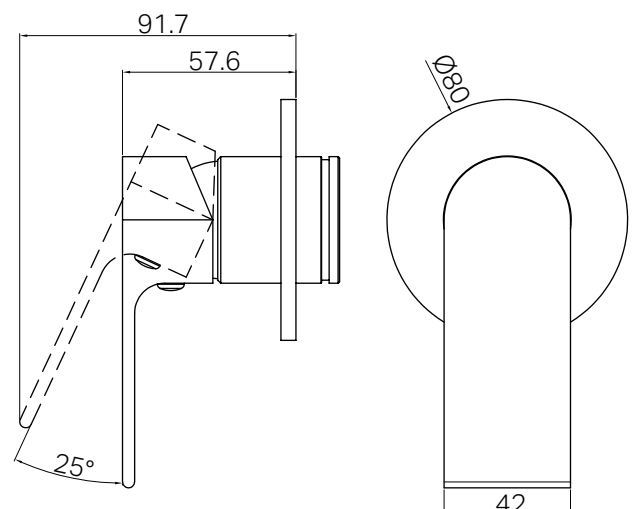

### Maintenance And Care

- Regularly check the mixer and connections for signs of wear or leaks.
- Clean the tap with mild soapy water to maintain its appearance, avoiding harsh chemicals and abrasive materials that may damage the finish.

- Dimensions are nominal measurements only.